

# Manhattan Community Board 4

(All Fields Must Be Completed)

## Liquor License Stipulations Application

APPLICANT		DOING BUSINESS AS (DBA)		
Fika 180 9th Avenue LLC		Fika		
STREET ADDRESS		CROSS STREETS		
180 9th Avenue, New York, NY		West 21st Street and West 22nd Street		
OWNER	NAME	Lars Akerlund & Michaela Wey	ATTORNEY NAME	Stacy L. Weiss, Esq.
	PHONE	646-837-6588	ATTORNEY PHONE	212-521-0828
	TAX	N/A	ATTORNEY TAX	212-521-0826
MANAGER	NAME	N/A	LANDLORD NAME	Related Companies
	PHONE	N/A	LANDLORD PHONE	(212) 801-1000
	TAX	N/A	LANDLORD TAX	N/A
DESCRIPTION OF BUSINESS				
Establishment Type:		<input type="radio"/> Bar/Tavern <input type="radio"/> Bed & Breakfast <input type="radio"/> Eating Place Beer <input type="radio"/> Cabaret <input type="radio"/> Night Club <input type="radio"/> Hotel <input type="radio"/> Restaurant <input type="radio"/> Catering Establishment <input type="radio"/> Club (Fraternal Organization – Members Only) <input checked="" type="checkbox"/> Other (Explain): <u>Cafe, bakery</u>		
Method of Operation:		<input type="radio"/> Restaurant <input type="radio"/> Dance Club <input type="radio"/> Sports Bar <input type="radio"/> Adult Entertainment <input type="radio"/> Wine Bar <input type="radio"/> Pizzeria <input type="radio"/> Cafe <input checked="" type="checkbox"/> Other (Explain): <u>Cafe, bakery</u>		
License Type:		<input type="radio"/> On-Premise <input type="radio"/> Wine <input type="radio"/> Beer <input checked="" type="checkbox"/> Wine & Beer		
APPLICATION TYPE <i>(check one)</i>	<input type="radio"/> New	Has applicant owned or managed a similar business?	<input checked="" type="radio"/> YES <input type="radio"/> NO	
		What is/was the name of establishment?	Fika	
		What is/was the address of the establishment?	See attached	
		What were the dates the applicant was involved with this former premise?		
	<input type="radio"/> Transfer	What is the prior license #?	N/A	
		What is the expiration date on the prior license?	N/A	
		Are you making any alterations or operational changes?	<input type="radio"/> YES <input type="radio"/> NO	
		<i>If alterations or operational changes are being made, please attach the plans to this form.</i>		
	<input type="radio"/> Alteration	What is the current license #?	N/A	
		What is the expiration date on the current license?	N/A	
<i>Please describe the nature of the alterations and attach the plans</i> N/A				

OPERATIONAL ISSUES										
HOURS		MONDAY	TUESDAY	WEDNESDAY	THURSDAY	FRIDAY	SATURDAY	SUNDAY		
	Operation	6:30am-10pm	6:30am-10pm	6:30am-10pm	6:30am-10pm	6:30am-10pm	6:30am-10pm	6:30am-10pm	6:30am-10pm	
	Music	6:30am-10pm	6:30am-10pm	6:30am-10pm	6:30am-10pm	6:30am-10pm	6:30am-10pm	6:30am-10pm	6:30am-10pm	
	Kitchen	6:30am-10pm	6:30am-10pm	6:30am-10pm	6:30am-10pm	6:30am-10pm	6:30am-10pm	6:30am-10pm	6:30am-10pm	
OCCUPANCY	INDOOR				BAR			OUTSIDE		
	Capacity (Certificate of Occupancy)	Maximum # of Persons You Anticipate Occupying Premises (Including Employees)	Number of Tables	Number of Seats	Number of Service Only Bars	Number of Stand-Up Bars	Number of Seats at Bars	Number of Seats	Number of Tables	
	40	35	12	30	1	0	0	N/A	N/A	
How many floors are there? What is the capacity for each floor? (please respond in space provided)					<input checked="" type="radio"/>	3-4	5-	1st fl & basement for storage		
Will you be applying or intending to apply for a cabaret license? If yes, will there be dancing? (please respond in space provided)					YES	<input checked="" type="radio"/>	N/A			
Will applicant have bottle service?					YES	<input checked="" type="radio"/>	N/A			
Will you be hosting private parties and promotional events?					YES	<input checked="" type="radio"/>	N/A			
Will outside promoters be used?					YES	<input checked="" type="radio"/>	N/A			
Will the security plan submitted be implemented?					YES	<input checked="" type="radio"/>	N/A			
Will State certified security personnel be used?					YES	NO	<input checked="" type="radio"/>			
Will New York Nightlife Association recommendations and NYPD Best Practices be followed?					<input checked="" type="radio"/>	NO	N/A			
Will the applicant be using delivery bicycles? If yes, have you applied to DOT for bicycle rack? Delivery bicycles are to be clearly marked with the name of the restaurant and staff will wear attire clearly noting name. (please respond in space provided)					YES	<input checked="" type="radio"/>	N/A			
Will the applicant be applying for a Sidewalk Café now or in the future? (please respond in space provided)					YES	<input checked="" type="radio"/>	N/A			
If yes to the above, are plans attached and submitted to DCA? How many tables/seats? (please respond in space provided)					YES	NO	<input checked="" type="radio"/>			
Will applicant provide contact information to neighbors and respond to complaints that arise?					<input checked="" type="radio"/>	NO	N/A			
If you plan to have music, what type(s)?			<input checked="" type="radio"/> BACKGROUND	<input type="radio"/> LIVE MUSIC	<input type="radio"/> DJ					
BUILDING DESIGN										
Doors and windows will be closed when any amplified music is played and in the event of no amplified sound, will be closed by 11 PM Friday and Saturday and 10 PM on all other days.					<input checked="" type="radio"/>	NO	N/A			
Will applicant follow the recommendations of a certified sound engineer to mitigate potential noise disturbance to the neighboring residents and buildings, including placing speakers on the floor of the establishment?					<input checked="" type="radio"/>	NO	N/A			
Do you agree to comply with DOB rules concerning a storm enclosure? Storm enclosures can be used between November 15 and April 15, but they may NOT project more than 18 inches from the store front.)					<input checked="" type="radio"/>	NO	N/A			

OUTDOOR ITEMS			
Will applicant use the rooftop, rear yard or any outdoor space?	YES	<input checked="" type="radio"/> NO	<input type="radio"/> N/A
If yes to the above, the rear yard, rooftop, and any outdoor space will be closed and vacated by 11 PM on Friday & Saturday and 10 PM on all other days.	YES	NO	<input checked="" type="radio"/> N/A
The service and consumption of alcohol in the rear yard, on the rooftop, or in any other outdoor space will be only via seated food service.	YES	NO	<input checked="" type="radio"/> N/A
The rear yard, rooftop, and any other outdoor space will not allow standing space for patrons to drink or smoke.	YES	NO	<input checked="" type="radio"/> N/A
Applicant will do everything in their power to provide an effective sound baffling or sound controlled environment through landscaping or some type of enclosure, where possible; provided they do not violate any fire or building code regulations? This includes possibly working with landlords for soundproofing tenants apartments (such as installing soundproofing windows, acoustical tiles, etc.).	YES	NO	<input checked="" type="radio"/> N/A
Applicant will enforce a quiet environment in the outdoor space, so as not to disturb nearby residents (e.g. there will be no amplified music, as per the law, and windows and doors to areas that play amplified music shall be closed). The applicant will make every effort possible to limit the noise emanating from diners by posting signs outside and also on menus asking for respect of the neighbor's privacy and peace. The staff will also encourage a peaceful environment amongst the outdoor diners.	YES	NO	<input checked="" type="radio"/> N/A
Applicant will have a lighting plan that will allow safe usage of the outdoor space without disrupting neighbors?	YES	NO	<input checked="" type="radio"/> N/A

LOCATION & ZONING			
Primary Zoning District:	C6-3A	Overlay (If Applicable):	N/A
Is this a Special District? If yes, is it Clinton, West Chelsea or Hudson Yards?	YES	<input checked="" type="radio"/> NO	<input type="radio"/> N/A
Does the building have a Certificate of Occupancy ("C of O") or a letter of no objection?	<input checked="" type="radio"/> YES	NO	<input type="radio"/> N/A
Is the 500 Foot Rule or 200 Foot Rule Triggered? If yes, which? Please attach a diagram of the establishments that triggers the rule.	YES	<input checked="" type="radio"/> NO	<input type="radio"/> N/A
Is a Public Assembly permit required?	YES	<input checked="" type="radio"/> NO	<input type="radio"/> N/A
Are your plans filed with DOB?	<input checked="" type="radio"/> YES	NO	<input type="radio"/> N/A
Building Type	<input type="radio"/> Residential <input type="radio"/> Commercial <input checked="" type="radio"/> Mixed Use <input type="radio"/> Other, describe: _____		
Adjacent Buildings	<input type="radio"/> Residential <input type="radio"/> Commercial <input type="radio"/> Mixed Use <input type="radio"/> Other, describe: _____		
NOTIFICATION: What organizations / community groups have you notified regarding your application?	# 1	To Be Provided	
	# 2		
	# 3		

Manhattan Community Board 4 (MCB4) recommends:	<input type="radio"/> Approval <input checked="" type="radio"/> <del>Denial unless all agreed to by applicant is part of the</del> <u>method of operation</u> <input type="radio"/> Denial
--	---

**CB4 REPRESENTATIVES**

 Nelly Gonzalez CB4 Community Associate	 Lisa Pughan CB4 BLP Committee Co-Chair	 Paul Seres CB4 BLP Committee Co-Chair
--	--	---

**APPLICANT AGREEMENT WITH THE COMMUNITY**

Pursuant to these stipulations, this applicant agrees to have these provisions incorporated in the method of operation of their liquor license. Additionally, the applicant agrees to the community agreements as the basis for the community supporting this application.

SIGN HERE →	SIGNATURE 	DATE 12/1/14 12/9/14
-------------	---	-------------------------

180 9th Ave

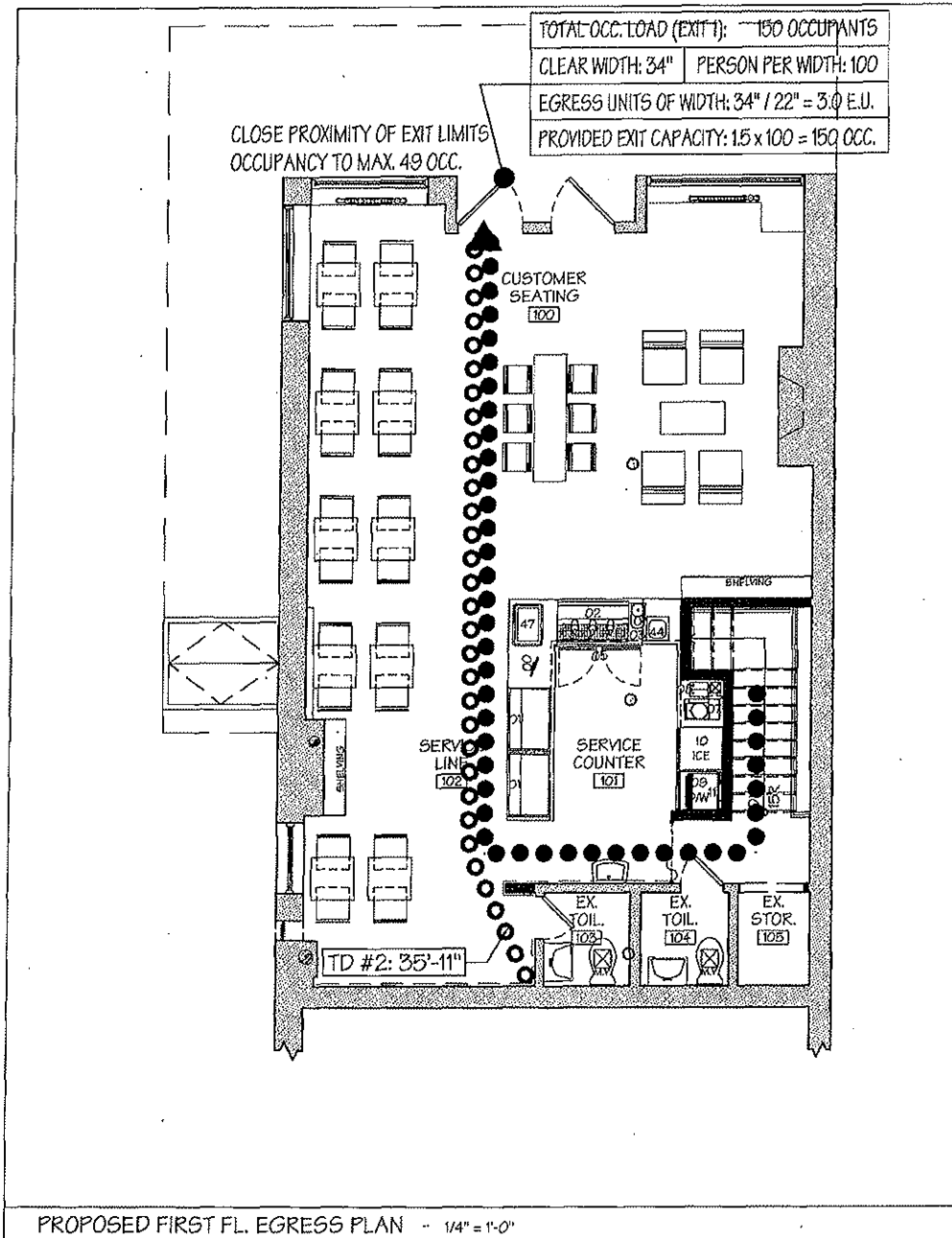

TASTE  
by  
**FIKA**

**- SANDWICHES -**

ALL SANDWICHES SERVED ON  
FRESH FIKA HOME MADE BREAD.

**SKAGEN \$11**

*Shrimp salad with dill & red  
onion on FIKA sourdough*

**ÖVERKALIX \$11**

*House cured salmon with arugula &  
cucumber served with sweet dill and  
mustard sauce on whole wheat wrap*

**BORLÄNGE \$9**

*Tuna salad with lime  
& sweet chili on FIKA sourdough*

**GÖTEBORG \$9**

*Swedish meatballs & red  
beet salad on FIKA rye*

**KARLSTAD \$10**

*Chicken breast & cranberry  
coleslaw on FIKA rye*

**HANASKOG \$10**

*Hummus & roasted  
red pepper on FIKA rye*

**SÖDERTÄLJE \$10**

*Chicken curry with sweet  
lingonberry jam on FIKA rye*

**HALF SOUP & HALF SANDWICH \$10**

**- SOUP OF THE WEEK -**

**ASK ABOUT OUR SOUP SELECTION!**

**- ENTREES -**

**MEATBALL PLATTER \$14**

*Swedish meatballs with mashed potatoes,  
creamy gravy, pickled cucumber & lingonberries  
served with mixed greens*

**GRAVLAX PLATTER \$15**

*House cured salmon with dill stewed fingerling  
potatoes, served with mixed greens & mustard sauce*

**- SALADS -**

**FIKA CEASAR \$10**

*with västerbotten cheese, bread  
croutons & ceasar dressing*

**MIXED GREENS \$9**

*with alfalfa sprouts, blue cheese, apples, cranberries,  
golden raisins, walnuts & honey mustard vinaigrette*

**ROASTED LOCAL BABY BEETS \$10**

*with goat cheese, endive, arugula, apples, roasted  
hazelnuts & hazelnut cardamom vinaigrette*

**KALE & WHEATBERRY \$10**

*with roasted butternut squash,  
pomegranate & maple vinaigrette*

**ADD A PROTEIN:**

*Gravlax, Chicken, Swedish Meatballs \$4/each*

**- SPECIALS -**

**ASK US ABOUT OUR WEEKLY  
AND DAILY SPECIALS!**

